



2010-15 Camaro Locking Fuel Door Installation Instructions

P/N: CC1004, CT1004, CB1006, CC1006, CS1006, 901490, 91, 92, 520, 521, 522



Included In Package:

- 1- Camaro Locking Fuel Door
- 1- Metal locking clip
- 2- Strips automotive tape
- 2- Keys

Tools Needed:

- Small Flat Head
- Screw Driver
- Diagonal Pliers
- File

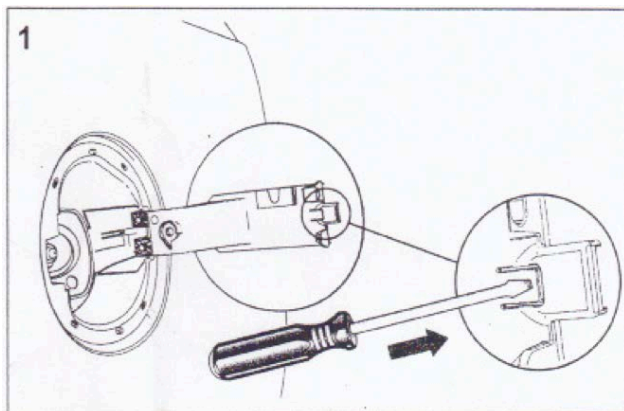

Step 1:

Open factory fuel door. Unlock tab on existing fuel door with small flat head and slide old door off.

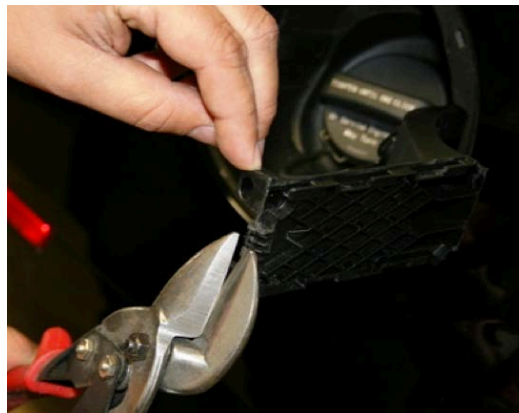

Step 2:

Cut off the portion of factory fuel door arm extending from the bracket.

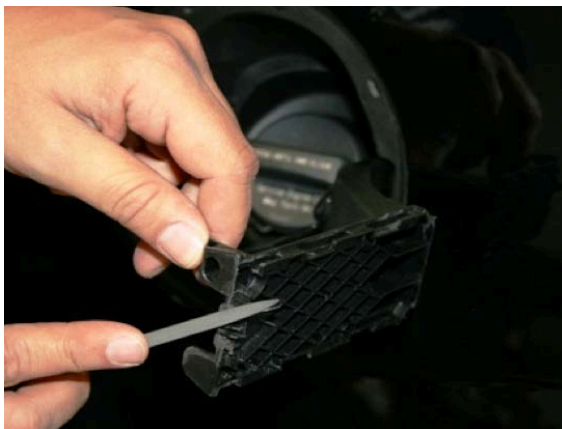

Step 3:

File and/or sand down the cut area to make as smooth as possible.

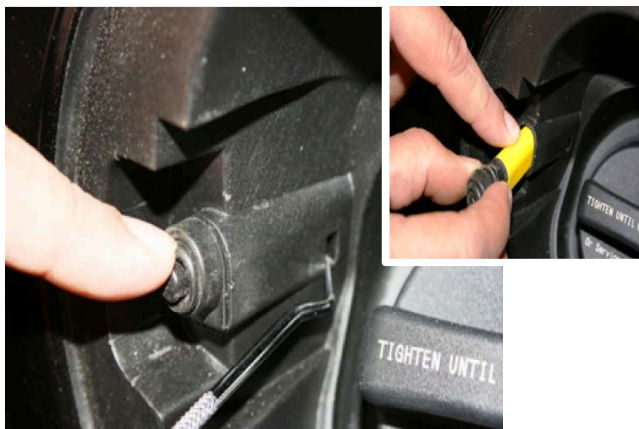

Step 4:

Use a pointed object to poke into the hole at the bottom of the locking housing to pry out locking mechanism. Once poked the mechanism should slide right out.



2010-15 Camaro Locking Fuel Door Installation Instructions

P/N: CC1004, CT1004, CB1006, CC1006, CS1006,
901490, 91, 92, 520, 521, 522



Included In Package:

- 1- Camaro Locking Fuel Door
- 1- Metal locking clip
- 2- Strips automotive tape
- 2- Keys

Tools Needed:

- Small Flat Head
Screw Driver
- Diagonal Pliers
- File



Step 5:

Take the metal locking clip (provided), slide onto the locking mechanism and clip into place. Slide the bottom of the yellow upwards.

Step 6

Press locking mechanism so internal plunger is extended. Cut extended piece off and push back in. Use two pieces of automotive tape (provided) and stick one piece on each side of locking mechanism.

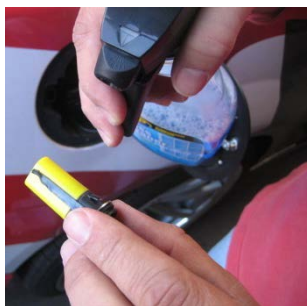

Step 7:

Peel off red backing from tape and spray with window cleaner, just enough to get moist.

Step 8:

Place the locking mechanism back into the lock housing with the tape applied and slide into place. Allow time for the tape to dry and adhere.



2010-15 Camaro Locking Fuel Door Installation Instructions



P/N: CC1004, CT1004,CB1006,CC1006,CS1006,
901490,91,92,520,521,522

Included In Package:

- 1- Camaro Locking Fuel Door
- 1- Metal locking clip
- 2- Strips automotive tape
- 2- Keys

Tools Needed:

- Small Flat Head
Screw Driver
- Diagonal Pliers
- File

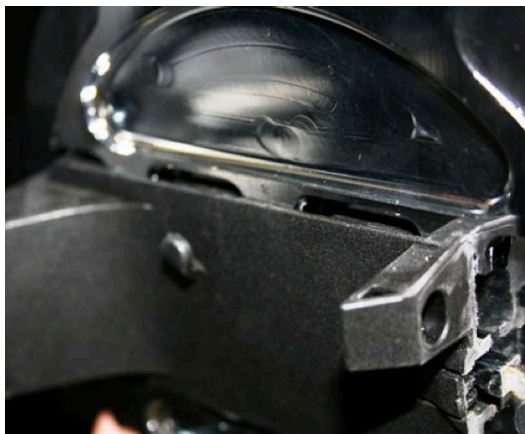
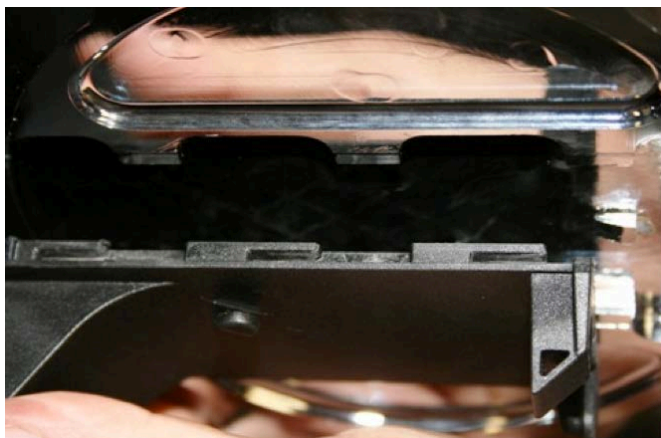

Step 9:

Notice the ridges (teeth) in the replacement fuel door as well as the rectangular fuel door bracket. Align the fuel door and rectangular bracket so the ridges fit into place. Push door down and slide over until the door locks into place.



Step 10:

Close door, test lock and verify proper installation before operating vehicle.